

NEW STEPS BETWEEN MAIN BARN AND AREA OVER STABLES.

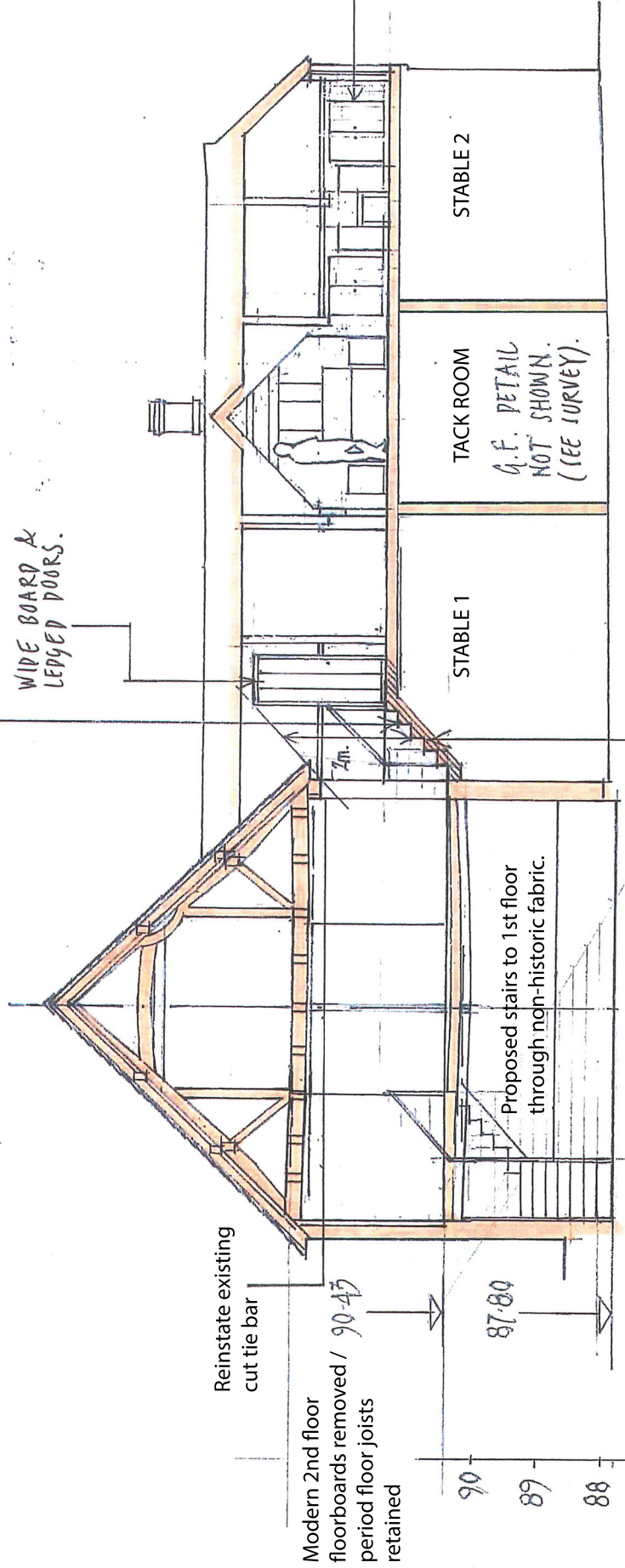

EXISTING SCREED TO BE REMOVED DOWN TO EXISTING CONCRETE OVER-SITE SLAB & NEW FLOOR FINISH LAID.

35 x 25 mm TREATED S.W. SPACER / INSULATION STOP BATTEN SCREW FIXED @ 900c/c

PROPOSED NARROW (600MM) TIMBER STEPS TO FORMER GROOM'S FLAT LEVEL. TRIM EXISTING FLOOR JOISTS & MAKE GOOD LATH & PLASTER CEILING (LATH & PLASTER TO SOFFIT OF STEPS).

SECTION A-A.

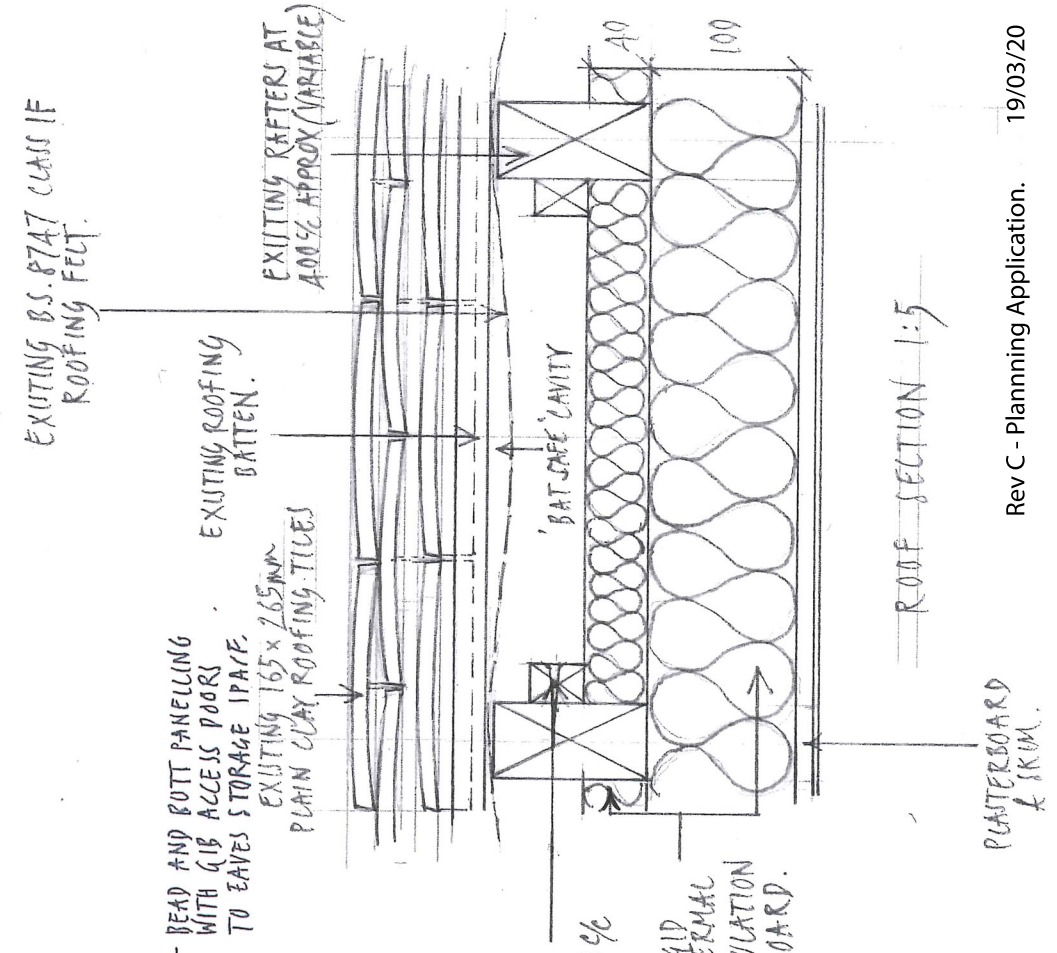

Rev C - Planning Application. 19/03/20

Rev B - Roof Section Added.

Rev A - Door removal, Floor joists added.

DWG N° 18/3158/203C

PROPOSED ALTERATIONS TO APPLESHAW BARN, APPLESHAW, ANDOVER. SECTIONS.
 SCALE 1:100 @ A3 @ RRPL MARY

SECTION LINE ON DWG N° 202.



SECTION B-B.

